

PRODUCT CROSS OVER REFERENCE:
Supplemental & Miniature Circuit Breakers
L8 & L9 Series B

L8 Supplementary Protectors Series B Crossover from Previous Series			
Old Catalog Number	New Series B		Series B Important Notes
	New Catalog Number	JDE Item Description Field or B2B SKU Field	
1-Pole, Curve B/C/D			
~	L8-0.5/1/B	L8-0.5/1/B B	New Series B Offering
L8-0.5/1/C	Same P/N. No change	L8-0.5/1/C B	Side Label Marked Series B Slight dimensional change from previous version
L8-0.5/1/D		L8-0.5/1/D B	
L8-1/1/B		L8-1/1/B B	
L8-1/1/C		L8-1/1/C B	
L8-1/1/D		L8-1/1/D B	
L8-2/1/B		L8-2/1/B B	
L8-2/1/C		L8-2/1/C B	
L8-2/1/D		L8-2/1/D B	
L8-3/1/B		L8-3/1/B B	
L8-3/1/C		L8-3/1/C B	
L8-3/1/D		L8-3/1/D B	
L8-4/1/B		L8-4/1/B B	
L8-4/1/C		L8-4/1/C B	
L8-4/1/D		L8-4/1/D B	
L8-5/1/B		L8-5/1/B B	
L8-5/1/C		L8-5/1/C B	
L8-5/1/D		L8-5/1/D B	
L8-6/1/B		L8-6/1/B B	
L8-6/1/C		L8-6/1/C B	
L8-6/1/D		L8-6/1/D B	
L8-7/1/B		L8-7/1/B B	
L8-7/1/C		L8-7/1/C B	
L8-7/1/D		L8-7/1/D B	
L8-8/1/B		L8-8/1/B B	
L8-8/1/C		L8-8/1/C B	
L8-8/1/D		L8-8/1/D B	
L8-10/1/B		L8-10/1/B B	
L8-10/1/C		L8-10/1/C B	
L8-10/1/D		L8-10/1/D B	
L8-13/1/B		L8-13/1/B B	
L8-13/1/C		L8-13/1/C B	
L8-13/1/D		L8-13/1/D B	
L8-15/1/B		L8-15/1/B B	
L8-15/1/C		L8-15/1/C B	
L8-15/1/D		L8-15/1/D B	
L8-16/1/B		L8-16/1/B B	
L8-16/1/C		L8-16/1/C B	
L8-16/1/D		L8-16/1/D B	
L8-20/1/B		L8-20/1/B B	
L8-20/1/C		L8-20/1/C B	
L8-20/1/D		L8-20/1/D B	
L8-25/1/B		L8-25/1/B B	
L8-25/1/C		L8-25/1/C B	
L8-25/1/D		L8-25/1/D B	
L8-30/1/B		L8-30/1/B B	
L8-30/1/C		L8-30/1/C B	
L8-30/1/D		L8-30/1/D B	
L8-32/1/B	L8-32/1/B B		
L8-32/1/C	L8-32/1/C B		
L8-32/1/D	L8-32/1/D B		
L8-40/1/B	L8-40/1/B B		
L8-40/1/C	L8-40/1/C B		
L8-40/1/D	L8-40/1/D B		
L8-50/1/B	L8-50/1/B B		
L8-50/1/C	L8-50/1/C B		
~	L8-50/1/D	L8-50/1/D B	New Series B Offering
L8-63/1/B	Same P/N	L8-63/1/B B	Side Label Marked Series B
L8-63/1/C	Same P/N	L8-63/1/C B	Side Label Marked Series B
~	L8-63/1/D	L8-63/1/D B	New Series B Offering

L8 Supplementary Protectors Series B Crossover from Previous Series			
Old Catalog Number	New Series B		Series B Important Notes
	New Catalog Number	JDE Item Description Field or B2B SKU Field	
2-Pole, Curve B/C/D			
~	L8-0.5/2/B	L8-0.5/2/B	New Series B Offering
L8-0.5/2/C	Same P/N. No change	L8-0.5/2/C B	Side Label Marked Series B Slight dimensional change from previous version
L8-0.5/2/D		L8-0.5/2/D B	
L8-1/2/B		L8-1/2/B B	
L8-1/2/C		L8-1/2/C B	
L8-1/2/D		L8-1/2/D B	
L8-2/2/B		L8-2/2/B B	
L8-2/2/C		L8-2/2/C B	
L8-2/2/D		L8-2/2/D B	
L8-3/2/B		L8-3/2/B B	
L8-3/2/C		L8-3/2/C B	
L8-3/2/D		L8-3/2/D B	
L8-4/2/B		L8-4/2/B B	
L8-4/2/C		L8-4/2/C B	
L8-4/2/D		L8-4/2/D B	
L8-5/2/B		L8-5/2/B B	
L8-5/2/C		L8-5/2/C B	
L8-5/2/D		L8-5/2/D B	
L8-6/2/B		L8-6/2/B B	
L8-6/2/C		L8-6/2/C B	
L8-6/2/D		L8-6/2/D B	
L8-7/2/B		L8-7/2/B B	
L8-7/2/C		L8-7/2/C B	
L8-7/2/D		L8-7/2/D B	
L8-8/2/B		L8-8/2/B B	
L8-8/2/C		L8-8/2/C B	
L8-8/2/D		L8-8/2/D B	
L8-10/2/B		L8-10/2/B B	
L8-10/2/C		L8-10/2/C B	
L8-10/2/D		L8-10/2/D B	
L8-13/2/B		L8-13/2/B B	
L8-13/2/C	L8-13/2/C B		
L8-13/2/D	L8-13/2/D B		
L8-15/2/B	L8-15/2/B B		
L8-15/2/C	L8-15/2/C B		
L8-15/2/D	L8-15/2/D B		
L8-16/2/B	L8-16/2/B B		
L8-16/2/C	L8-16/2/C B		
L8-16/2/D	L8-16/2/D B		
L8-20/2/B	L8-20/2/B B		
L8-20/2/C	L8-20/2/C B		
L8-20/2/D	L8-20/2/D B		
L8-25/2/B	L8-25/2/B B		
L8-25/2/C	L8-25/2/C B		
L8-25/2/D	L8-25/2/D B		
L8-30/2/B	L8-30/2/B B		
L8-30/2/C	L8-30/2/C B		
L8-30/2/D	L8-30/2/D B		
L8-32/2/B	L8-32/2/B B		
L8-32/2/C	L8-32/2/C B		
L8-32/2/D	L8-32/2/D B		
L8-40/2/B	L8-40/2/B B		
L8-40/2/C	L8-40/2/C B		
L8-40/2/D	L8-40/2/D B		
L8-50/2/B	L8-50/2/B B		
L8-50/2/C	L8-50/2/C B		
~	L8-50/2/D	L8-50/2/D B	New Series B Offering
L8-63/2/B	Same P/N	L8-63/2/B B	Side Label Marked Series B
L8-63/2/C	Same P/N	L8-63/2/C B	Side Label Marked Series B
~	L8-63/2/D	L8-63/2/D B	New Series B Offering

L8 Supplementary Protectors Series B Crossover from Previous Series			
Old Catalog Number	New Series B		Series B Important Notes
	New Catalog Number	JDE Item Description Field or B2B SKU Field	
3-Pole, Curve B/C/D			
~	L8-0.5/3/B	L8-0.5/3/B B	New Series B Offering
L8-0.5/3/C	Same P/N	L8-0.5/3/C B	Side Label Marked Series B. Slight dimensional change from previous version
~	L8-0.5/3/D	L8-0.5/3/D B	New Series B Offering
L8-1/3/B	Same P/N. No change	L8-1/3/B B	Side Label Marked Series B Slight dimensional change from previous version
L8-1/3/C		L8-1/3/C B	
L8-1/3/D		L8-1/3/D B	
L8-2/3/B		L8-2/3/B B	
L8-2/3/C		L8-2/3/C B	
L8-2/3/D		L8-2/3/D B	
L8-3/3/B		L8-3/3/B B	
L8-3/3/C		L8-3/3/C B	
L8-3/3/D		L8-3/3/D B	
L8-4/3/B		L8-4/3/B B	
L8-4/3/C		L8-4/3/C B	
L8-4/3/D		L8-4/3/D B	
L8-5/3/B		L8-5/3/B B	
L8-5/3/C		L8-5/3/C B	
L8-5/3/D		L8-5/3/D B	
L8-6/3/B		L8-6/3/B B	
L8-6/3/C		L8-6/3/C B	
L8-6/3/D		L8-6/3/D B	
L8-7/3/B		L8-7/3/B B	
L8-7/3/C		L8-7/3/C B	
L8-7/3/D		L8-7/3/D B	
L8-8/3/B		L8-8/3/B B	
L8-8/3/C		L8-8/3/C B	
L8-8/3/D		L8-8/3/D B	
L8-10/3/B		L8-10/3/B B	
L8-10/3/C		L8-10/3/C B	
L8-10/3/D		L8-10/3/D B	
L8-13/3/B		L8-13/3/B B	
L8-13/3/C		L8-13/3/C B	
L8-13/3/D		L8-13/3/D B	
L8-15/3/B		L8-15/3/B B	
L8-15/3/C		L8-15/3/C B	
L8-15/3/D		L8-15/3/D B	
L8-16/3/B		L8-16/3/B B	
L8-16/3/C		L8-16/3/C B	
L8-16/3/D		L8-16/3/D B	
L8-20/3/B		L8-20/3/B B	
L8-20/3/C		L8-20/3/C B	
L8-20/3/D		L8-20/3/D B	
L8-25/3/B		L8-25/3/B B	
L8-25/3/C	L8-25/3/C B		
L8-25/3/D	L8-25/3/D B		
L8-30/3/B	L8-30/3/B B		
L8-30/3/C	L8-30/3/C B		
L8-30/3/D	L8-30/3/D B		
L8-32/3/B	L8-32/3/B B		
L8-32/3/C	L8-32/3/C B		
L8-32/3/D	L8-32/3/D B		
L8-40/3/B	L8-40/3/B B		
L8-40/3/C	L8-40/3/C B		
L8-40/3/D	L8-40/3/D B		
L8-50/3/B	L8-50/3/B B		
L8-50/3/C	L8-50/3/C B		
~	L8-50/3/D	L8-50/3/D B	New Series B Offering
L8-63/3/B	Same P/N.	L8-63/3/B B	Side Label Marked Series B. Slight dimensional change
L8-63/3/C	Same P/N.	L8-63/3/C B	Side Label Marked Series B. Slight dimensional change
~	L8-63/3/D	L8-63/3/D B	New Series B Offering

L8 Supplementary Protectors Series B Crossover from Previous Series				
Old Catalog Number	New Series B		Series B Important Notes	
	New Catalog Number	JDE Item Description Field or B2B SKU Field		
L8 Accessories				
Z8-ASA24	L8-AST1	L8-AST1	Mixing Series Not Possible, Not Interchangeable	
Z8-ASA230	L8-AST2	L8-AST2	Mixing Series Not Possible, Not Interchangeable	
Z8-USA115	~	~	No Cross in Series B	
Z8-USA230	~	~	No Cross in Series B	
~	L8-ASCR3	L8-ASCR3	Aux/Signal Contact 1CO. Mixing Series Not Possible, Not Interchangeable.	
~	L8-ALOA1	L8-ALOA1	L9 Lockout 1-Pole. Mixing Series Not Possible, Not Interchangeable.	
~	L8-ALOA2	L8-ALOA2	L9 Lockout 2 & 3 Pole. Mixing Series Not Possible, Not Interchangeable.	
LX-AHS3	~	~	Aux/Signal Contact 2 Form-C. Mixing Series Not Possible, Not Interchangeable.	
L8 Bus Bar System				
FHL8-A1B1	L8-A1B1	L8-A1B1	FHL8 & L8 Bus Bars are Interchangeable with all L8 Series. Note: FHL8 will state FH8 Fuse holders on product label	
FHL8-A1B1H	L8-A1B1H	L8-A1B1H		
FHL8-A1B8	L8-A1B8	L8-A1B8		
FHL8-A1B8H	L8-A1B8H	L8-A1B8H		
FHL8-A1E	L8-A1E	L8-A1E		
FHL8-A2B1	L8-A2B1	L8-A2B1		
FHL8-A2B1H	L8-A2B1H	L8-A2B1H		
FHL8-A2B8	L8-A2B8	L8-A2B8		
FHL8-A2B8H	L8-A2B8H	L8-A2B8H		
FHL8-A3B1	L8-A3B1	L8-A3B1		
FHL8-A3B1H	L8-A3B1H	L8-A3B1H		
FHL8-A3B8	L8-A3B8	L8-A3B8		
FHL8-A3B8H	L8-A3B8H	L8-A3B8H		
FHL8-AAP	L8-AAP	L8-AAP		
FHL8-AAT1	L8-AAT1	L8-AAT1		
FHL8-AME	L8-AME	L8-AME		
~	L8-AAT1S	L8-AAT1S		New bus bar item for L8 Series B
~	L8-AAT1LP	L8-AAT1LP		New bus bar item for L8 Series B
~	L8-AAT2	L8-AAT2		New bus bar item for L8 Series B

L8 Dimensions

Dimensions are in millimeters (inches). Dimensions not intended for manufacturing purposes.

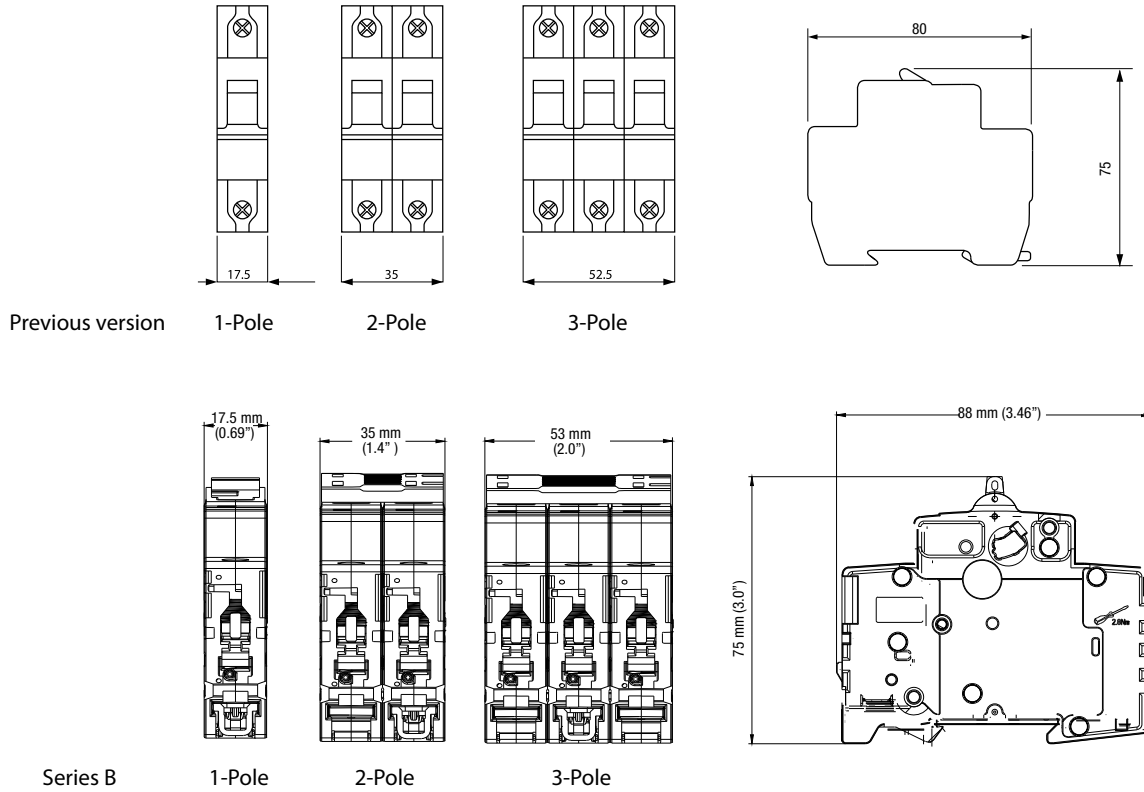

L8-ASCR3

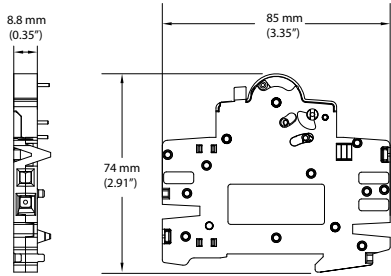

LX-AHS3

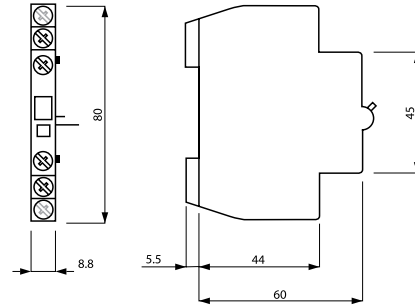

L8-AST1/2

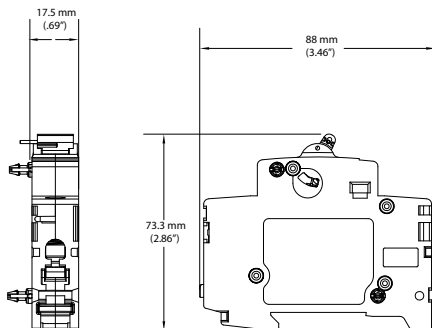

Z8-ASA

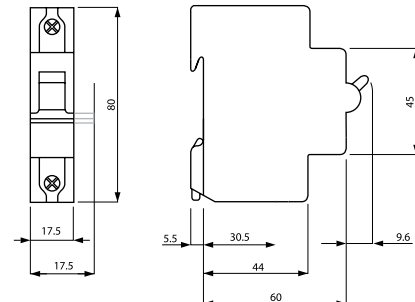

Applying L8 Bus Bars & Accessories

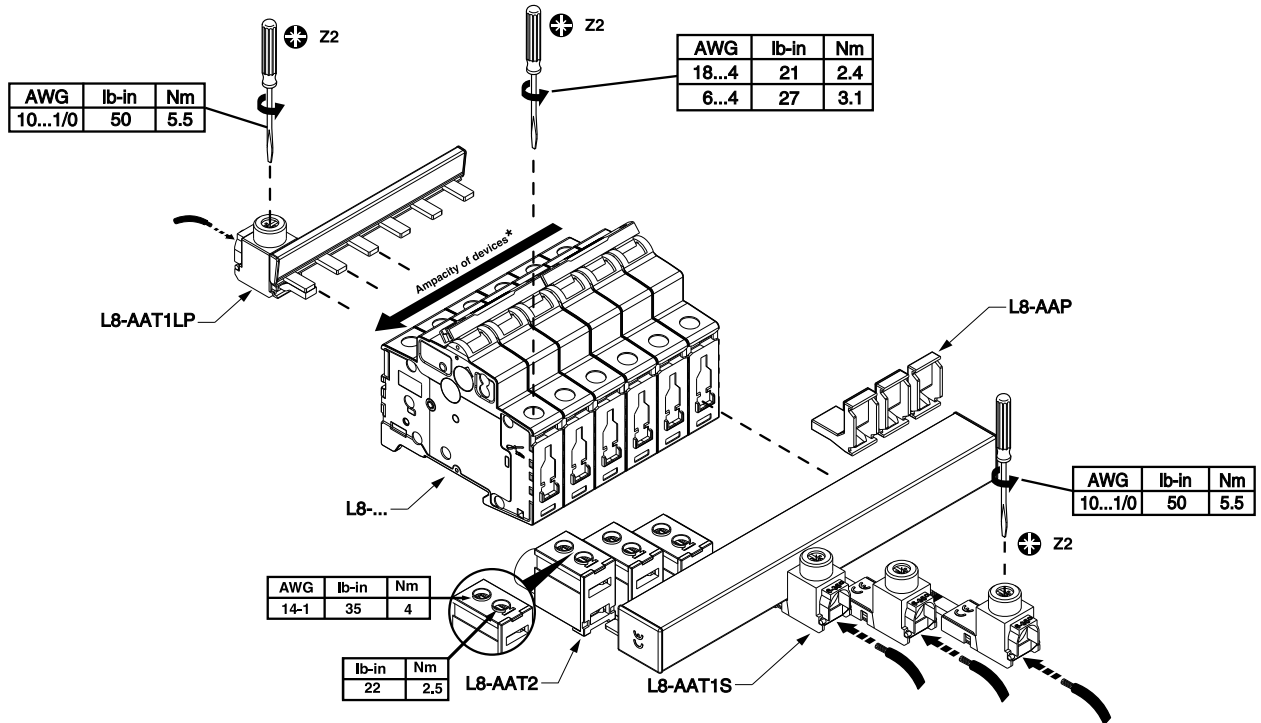

80AMP

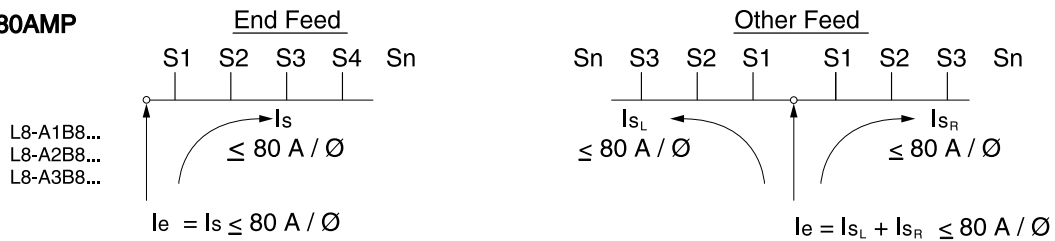

100AMP

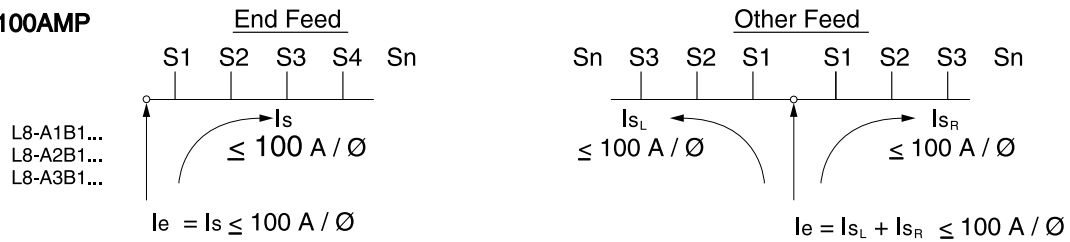

- L8 bus bars remain the same with only a prefix change from FHL8-xxx to L8-xxx

L8-AST1/2 Shunt Trip Assembly

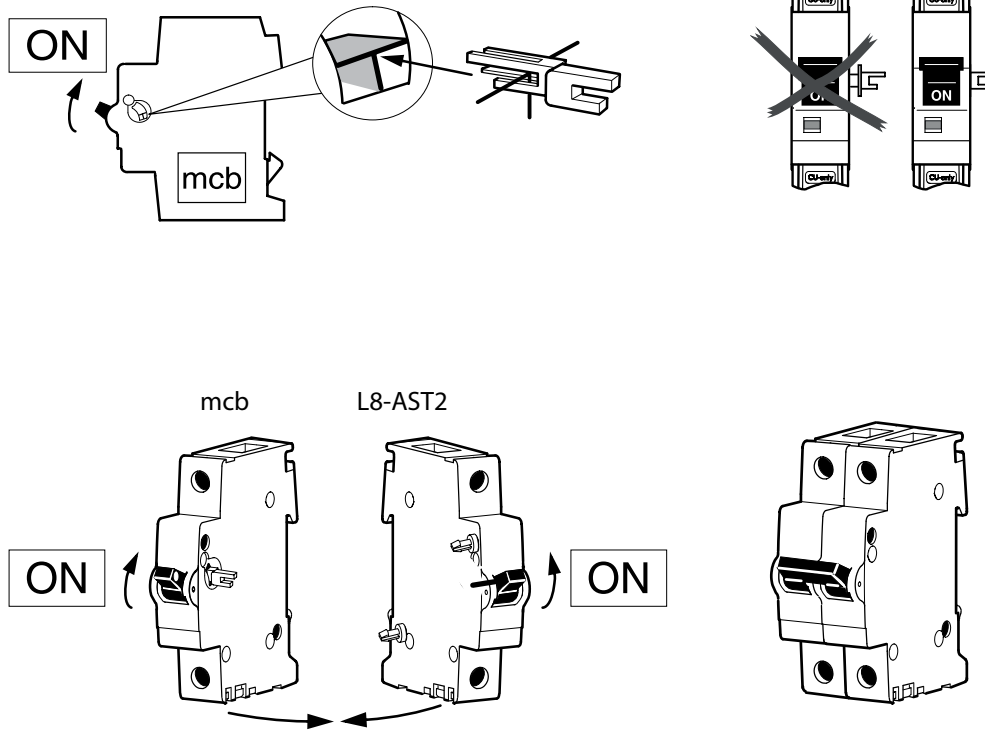

L8-ASCR3 Auxiliaries Assembly

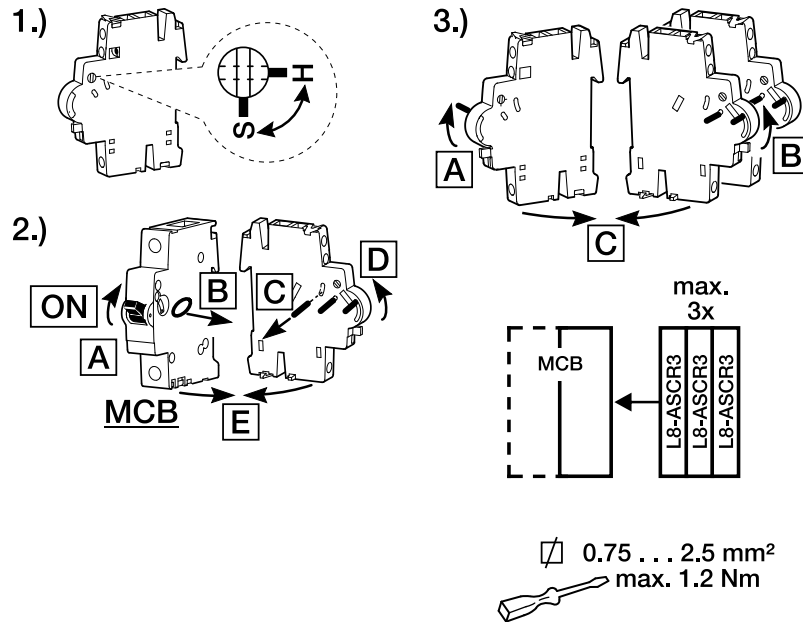

The device contains a slight amount of CuBe.

L8 2-pole Terminal Connections

New Series B

Previous Version



L8 3-pole Side by Side Comparison

New Series B

Previous Version

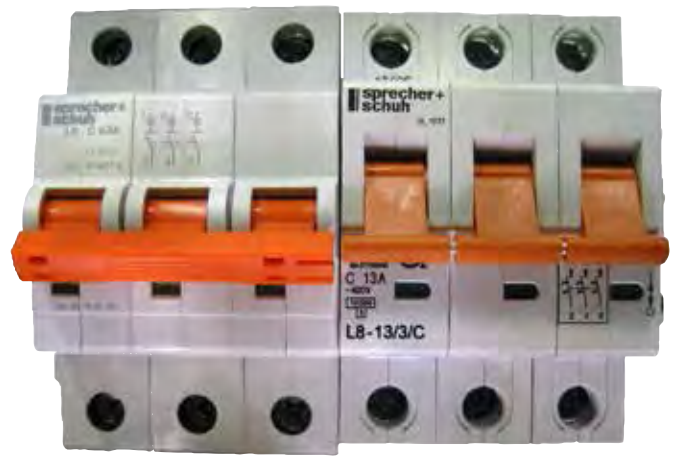

L9 3-pole Terminal Connections

New Series B

Previous Version



L9 2-pole Side by Side Comparison

New Series B

Previous Version



All Series B versions of L8 and L9 units are clearly marked Series B on the side label.

L9 Circuit Breaker Series B Crossover from Previous Series				
Old Catalog Number	New Series B		Series B Important Notes	
	New Catalog Number	JDE Item Description Field or B2B SKU Field		
1-Pole, Curve C/D				
L9-.5/1/C	L9-0.5/1/C	L9-0.5/1/C B	Side Label Marked Series B.	
L9-.5/1/D	L9-0.5/1/D	L9-0.5/1/D B	Slight dimensional change from previous version	
L9-1.5/1/C	~	~	No cross, consider new 1.6A	
L9-1.5/1/D	~	~	No cross, consider new 1.6A	
~	L9-1.6/1/C	L9-1.6/1/C B	New Series B Offering	
~	L9-1.6/1/D	L9-1.6/1/D B	New Series B Offering	
L9-1/1/C	Same P/N No Change	L9-1/1/C B		
L9-1/1/D		L9-1/1/D B		
L9-2/1/C		L9-2/1/C B		
L9-2/1/D		L9-2/1/D B		
L9-3/1/C		L9-3/1/C B		
L9-3/1/D		L9-3/1/D B		
L9-4/1/C		L9-4/1/C B		
L9-4/1/D		L9-4/1/D B		
L9-5/1/C		L9-5/1/C B		
L9-5/1/D		L9-5/1/D B		
L9-6/1/C		L9-6/1/C B		
L9-6/1/D		L9-6/1/D B		
L9-7/1/C		L9-7/1/C B		
L9-7/1/D		L9-7/1/D B		
L9-8/1/C		L9-8/1/C B		
L9-8/1/D		L9-8/1/D B		
L9-10/1/C		L9-10/1/C B		
L9-10/1/D		L9-10/1/D B		
L9-13/1/C		L9-13/1/C B		Side Label Marked Series B.
L9-13/1/D		L9-13/1/D B		Slight dimensional change from previous version
L9-15/1/C		L9-15/1/C B		
L9-15/1/D		L9-15/1/D B		
L9-16/1/C		L9-16/1/C B		
L9-16/1/D		L9-16/1/D B		
L9-20/1/C		L9-20/1/C B		
L9-20/1/D		L9-20/1/D B		
L9-25/1/C		L9-25/1/C B		
L9-25/1/D		L9-25/1/D B		
L9-30/1/C		L9-30/1/C B		
L9-30/1/D		L9-30/1/D B		
L9-32/1/C	L9-32/1/C B			
L9-32/1/D	L9-32/1/D B			
L9-35/1/C	L9-35/1/C B			
L9-35/1/D	L9-35/1/D B			
L9-40/1/C	L9-40/1/C B			
L9-40/1/D	L9-40/1/D B			
~	L9-50/1/C	L9-50/1/C B	New Series B Offering	
~	L9-50/1/D	L9-50/1/D B	New Series B Offering	
~	L9-60/1/C	L9-60/1/C B	New Series B Offering	
~	L9-60/1/D	L9-60/1/D B	New Series B Offering	
~	L9-63/1/C	L9-63/1/C B	New Series B Offering	
~	L9-63/1/D	L9-63/1/D B	New Series B Offering	

L9 Circuit Breaker Series B Crossover from Previous Series				
Old Catalog Number	New Series B		Series B Important Notes	
	New Catalog Number	JDE Item Description Field or B2B SKU Field		
2-Pole, Curve C/D				
L9-.5/2/C	L9-0.5/2/C	L9-0.5/2/C B	Side Label Marked Series B.	
L9-.5/2/D	L9-0.5/2/D	L9-0.5/2/D B	Slight dimensional change from previous version	
L9-1.5/2/C	~	~	No cross, consider new 1.6A	
L9-1.5/2/D	~	~	No cross, consider new 1.6A	
~	L9-1.6/2/C	L9-1.6/2/C B	New Series B Offering	
~	L9-1.6/2/D	L9-1.6/2/D B	New Series B Offering	
L9-1/2/C	Same P/N No Change	L9-1/2/C B		
L9-1/2/D		L9-1/2/D B		
L9-2/2/C		L9-2/2/C B		
L9-2/2/D		L9-2/2/D B		
L9-3/2/C		L9-3/2/C B		
L9-3/2/D		L9-3/2/D B		
L9-4/2/C		L9-4/2/C B		
L9-4/2/D		L9-4/2/D B		
L9-5/2/C		L9-5/2/C B		
L9-5/2/D		L9-5/2/D B		
L9-6/2/C		L9-6/2/C B		
L9-6/2/D		L9-6/2/D B		
L9-7/2/C		L9-7/2/C B		
L9-7/2/D		L9-7/2/D B		
L9-8/2/C		L9-8/2/C B		
L9-8/2/D		L9-8/2/D B		
L9-10/2/C		L9-10/2/C B		
L9-10/2/D		L9-10/2/D B		Side Label Marked Series B.
L9-13/2/C		L9-13/2/C B		Slight dimensional change from previous version
L9-13/2/D		L9-13/2/D B		
L9-15/2/C		L9-15/2/C B		
L9-15/2/D		L9-15/2/D B		
L9-16/2/C		L9-16/2/C B		
L9-16/2/D		L9-16/2/D B		
L9-20/2/C		L9-20/2/C B		
L9-20/2/D		L9-20/2/D B		
L9-25/2/C		L9-25/2/C B		
L9-25/2/D		L9-25/2/D B		
L9-30/2/C	L9-30/2/C B			
L9-30/2/D	L9-30/2/D B			
L9-32/2/C	L9-32/2/C B			
L9-32/2/D	L9-32/2/D B			
L9-35/2/C	L9-35/2/C B			
L9-35/2/D	L9-35/2/D B			
L9-40/2/C	L9-40/2/C B			
L9-40/2/D	L9-40/2/D B			
~	L9-50/2/C	L9-50/2/C B	New Series B Offering	
~	L9-50/2/D	L9-50/2/D B	New Series B Offering	
~	L9-60/2/C	L9-60/2/C B	New Series B Offering	
~	L9-60/2/D	L9-60/2/D B	New Series B Offering	
~	L9-63/2/C	L9-63/2/C B	New Series B Offering	
~	L9-63/2/D	L9-63/2/D B	New Series B Offering	

L9 Circuit Breaker Series B Crossover from Previous Series				
Old Catalog Number	New Series B		Series B Important Notes	
	New Catalog Number	JDE Item Description Field or B2B SKU Field		
3-Pole, Curve C/D				
L9-.5/3/C	L9-0.5/3/C	L9-0.5/3/C B	Side Label Marked Series B.	
L9-.5/3/D	L9-0.5/3/D	L9-0.5/3/D B	Slight dimensional change from previous version	
L9-1.5/3/C	~	~	No cross, consider new 1.6A	
L9-1.5/3/D	~	~	No cross, consider new 1.6A	
~	L9-1.6/3/C	L9-1.6/3/C B	New Series B Offering	
~	L9-1.6/3/D	L9-1.6/3/D B	New Series B Offering	
L9-1/3/C	Same P/N No Change	L9-1/3/C B		
L9-1/3/D		L9-1/3/D B		
L9-2/3/C		L9-2/3/C B		
L9-2/3/D		L9-2/3/D B		
L9-3/3/C		L9-3/3/C B		
L9-3/3/D		L9-3/3/D B		
L9-4/3/C		L9-4/3/C B		
L9-4/3/D		L9-4/3/D B		
L9-5/3/C		L9-5/3/C B		
L9-5/3/D		L9-5/3/D B		
L9-6/3/C		L9-6/3/C B		
L9-6/3/D		L9-6/3/D B		
L9-7/3/C		L9-7/3/C B		
L9-7/3/D		L9-7/3/D B		
L9-8/3/C		L9-8/3/C B		
L9-8/3/D		L9-8/3/D B		
L9-10/3/C		L9-10/3/C B		
L9-10/3/D		L9-10/3/D B		Side Label Marked Series B.
L9-13/3/C		L9-13/3/C B		Slight dimensional change from previous version
L9-13/3/D		L9-13/3/D B		
L9-15/3/C		L9-15/3/C B		
L9-15/3/D		L9-15/3/D B		
L9-16/3/C		L9-16/3/C B		
L9-16/3/D		L9-16/3/D B		
L9-20/3/C		L9-20/3/C B		
L9-20/3/D		L9-20/3/D B		
L9-25/3/C		L9-25/3/C B		
L9-25/3/D		L9-25/3/D B		
L9-30/3/C		L9-30/3/C B		
L9-30/3/D		L9-30/3/D B		
L9-32/3/C	L9-32/3/C B			
L9-32/3/D	L9-32/3/D B			
L9-35/3/C	L9-35/3/C B			
L9-35/3/D	L9-35/3/D B			
L9-40/3/C	L9-40/3/C B			
L9-40/3/D	L9-40/3/D B			
~	L9-50/3/C	L9-50/3/C B	New Series B Offering	
~	L9-50/3/D	L9-50/3/D B	New Series B Offering	
~	L9-60/3/C	L9-60/3/C B	New Series B Offering	
~	L9-60/3/D	L9-60/3/D B	New Series B Offering	
~	L9-63/3/C	L9-63/3/C B	New Series B Offering	
~	L9-63/3/D	L9-63/3/D B	New Series B Offering	

L9 Circuit Breaker Series B Crossover from Previous Series				
Old Catalog Number	New Series B		Series B Important Notes	
	New Catalog Number	JDE Item Description Field or B2B SKU Field		
L9 Accessories				
~	L9-AMRA3	L9-AMRA3	Signal Contact 1CO. Mixing Series Not Possible, Not Interchangeable.	
~	L9-AMRS3	L9-AMRS3	Auxiliary Contact 1CO. Mixing Series Not Possible, Not Interchangeable.	
LX-AHS3	~	~	Aux/Signal Contact 2 Form-C. Mixing Series Not Possible, Not Interchangeable.	
L9-ABH12	~	~	Auxiliary Contact NO/NC. Mixing Series Not Possible, Not Interchangeable.	
L9-ASTA1	L9-AMST1	L9-AMST1	Mixing Series Not Possible, Not Interchangeable.	
L9-ASTA2	L9-AMST2	L9-AMST2	Mixing Series Not Possible, Not Interchangeable.	
L9-AALOA	~	~	L9 Lockout All Poles. Mixing Series Not Possible, Not Interchangeable.	
~	L8-ALOA1	L8-ALOA1	L9 Lockout 1-Pole. Mixing Series Not Possible, Not Interchangeable.	
~	L8-ALOA2	L8-ALOA2	L9 Lockout 2 & 3 Pole. Mixing Series Not Possible, Not Interchangeable.	
L9 Bus Bar System				
L9-AACL106	L9-AMCL106	L9-AMCL106	New bus bar system. Mixing Series Not Possible, Not Interchangeable.	
L9-AACL112	L9-AMCL112	L9-AMCL112		
L9-AACL118	L9-AMCL118	L9-AMCL118		
L9-AACL206	L9-AMCL206	L9-AMCL206		
L9-AACL212	L9-AMCL212	L9-AMCL212		
L9-AACL218	L9-AMCL218	L9-AMCL218		
L9-AACL306	L9-AMCL306	L9-AMCL306		
L9-AACL312	L9-AMCL312	L9-AMCL312		
L9-AACL318	L9-AMCL318	L9-AMCL318		
L9-AACLPS	L9-AMCLPS	L9-AMCLPS		
L9-AACLT35	L9-AMCLT35	L9-AMCLT35		
~	L9-AMCLT50D	L9-AMCLT50D		New bus bar item for L9 Series B

L9 Series B Dimensions

Dimensions are in millimeters (inches). Dimensions not intended for manufacturing purposes.

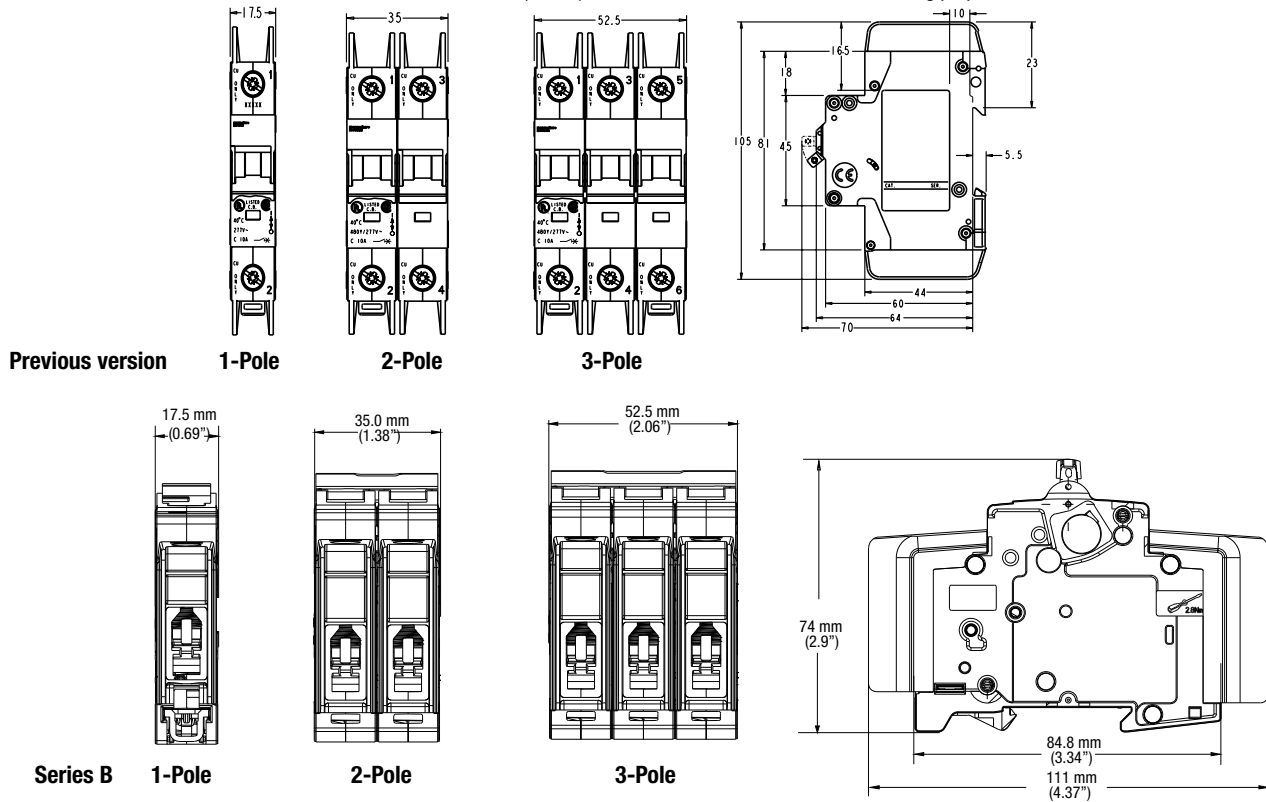

L9-AMRA3/AMRS3

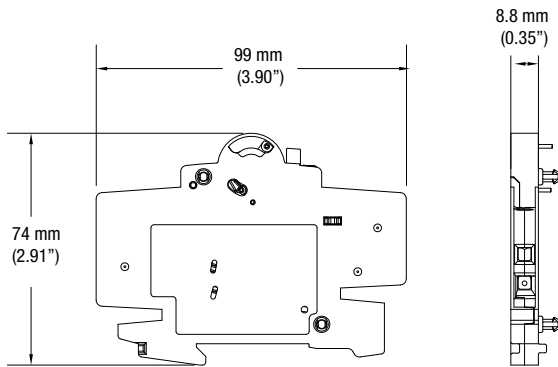

L9-ABH12

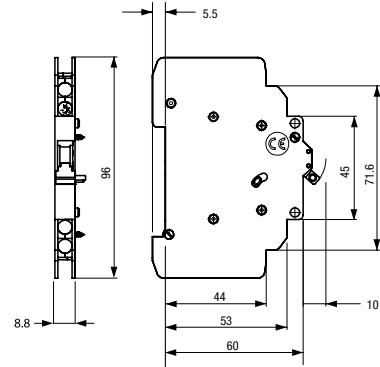

L9-AMST1/2

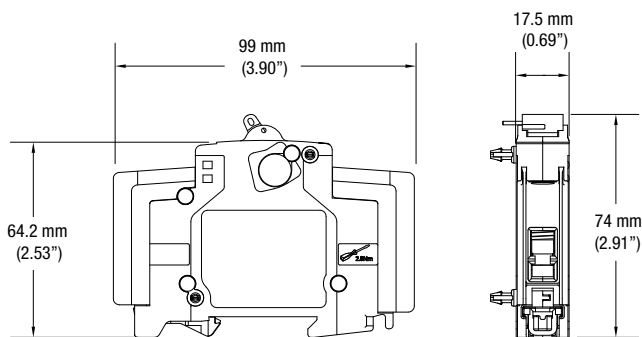

L9-ASTA1/2

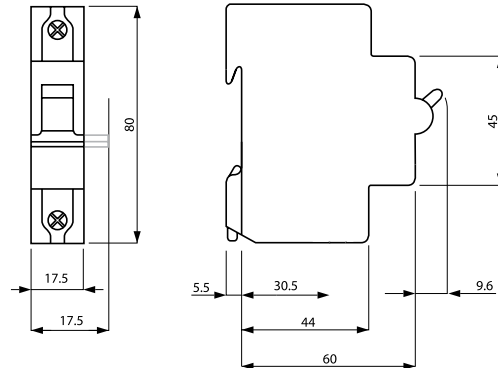

Applying L9 Bus Bars & Accessories

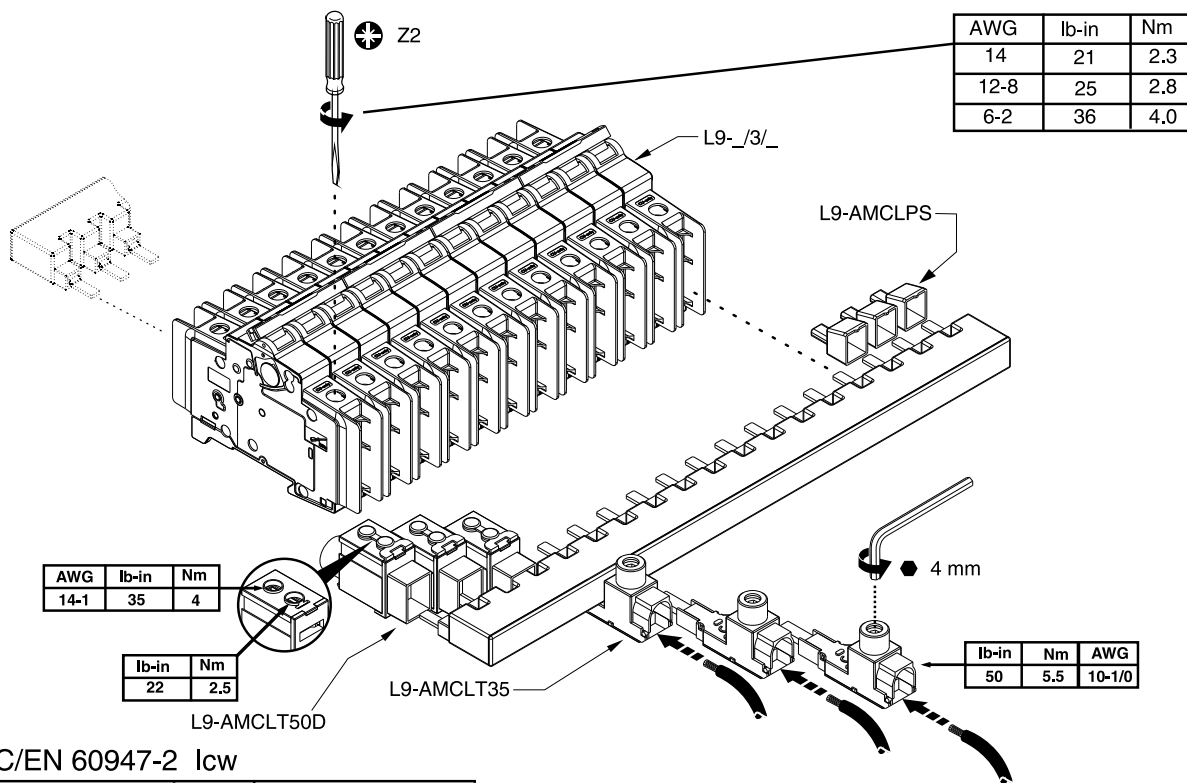

IEC/EN 60947-2 Icw

Ue t = 1s L9-AMCL	Ue VAC	L9-AMCL Icw Amps
	240/ 415	10000

UL SCCR

Ue L9-AMCL	L9-_/_/_ In Amps	Ue VAC	L9-AMCL SCCR RMS Sym Amps
	0.5-25	480Y/ 277	10000
	30-40	240	10000

	L9-_/1/_	L9-_/2/_	L9-_/3/_	
	L9-AMCL106	6	-	-
	L9-AMCL112	12	-	-
	L9-AMCL118	18	-	-
	L9-AMCL206	-	3	-
	L9-AMCL212	-	6	-
	L9-AMCL218	-	9	-
	L9-AMCL306	-	-	2
	L9-AMCL312	-	-	4
	L9-AMCL318	-	-	6
	L9-AMCL35	1	2	3
	L9-AMCL50D	1	2	3

NOTE: Do not cut bus bars. Maximum of 3 bus bars allowed in any combination of the same phase configuration. Multiple bus bars must be installed back-to-back.

L9-AMRA3 Auxiliary Contact Assembly

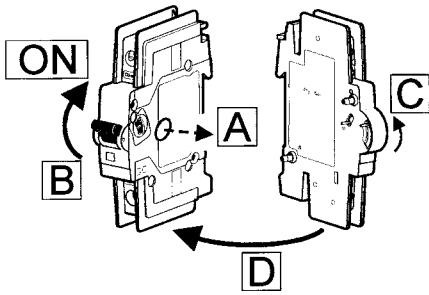

Field mountable to Circuit Breaker type L9.

Up to two auxiliary switches can be mounted on the right hand side of the Circuit Breaker.

Function of the auxiliary switch

The auxiliary switch indicates the switching position of the circuit breaker, irrespective of whether the switching position is attributable to manual operation or fault tripping.

Installation

1. remove coupling cover on the right hand side of the circuit breaker
 2. circuit breaker in ON position
 3. auxiliary switch in ON position
- Repeat same procedure when fitting a second auxiliary switch at the right hand side of the first auxiliary switch.

Function TEST

When switching the MCB from ON to OFF position and vice versa make sure the auxiliary contact function simultaneously follows the position of the MCB.

Connection parameters

Wire size: 0.75 ... 2.5 mm² (18 – 14 AWG)
Tightening torque: 1.2 Nm max. (10.6 lbs. In)

Disposal

The device contains small amounts of CuBe, therefore check for any existing pertinent domestic disposal provisions.

L9-AMRS3 Signal Contact Assembly

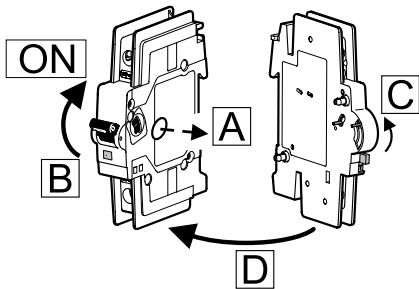

Field mountable to Circuit Breaker type L9.

Up to two alarm switches of type L9-AMRS3 can be mounted once on the right side of the Circuit Breaker.

Function of the signal contact

The signal contacts is used to monitor the trip states of the circuit breaker. In case of a trip the status of the c/o contact changes and the orange reset button is released. The alarm signal can be acknowledged and switched off by pressing the reset button.

Installation

1. remove coupling cover on the right hand side of the circuit breaker
 2. circuit breaker in ON position
 3. signal contact in ON position
- Repeat same procedure when fitting a second signal contact at the right hand side of the first signal contact.

Function control test

When switching the MCB from ON to OFF position and vice versa make sure the signal contact function simultaneously follows the position of the MCB.

The proper function of the signal contact can be tested with the test button without tripping the MCB itself. When pressing the test button the signal contact will be switched over and the orange reset button will be released. This can be tested in either position of the MCB.

Test functions (contact position)

In ON and OFF position after manual operation

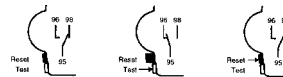

in OFF position after tripping

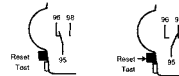

Connection parameters

Wire size: 0.75 ... 2.5 mm² (18 – 14 AWG)
Tightening torque: 1.2 Nm max. (10.6 lbs. In)

Disposal

The device contains small amounts of CuBe, therefore check for any existing pertinent domestic disposal provisions.

L9-AMST1/L9-AMST2 Shunt Trip Assembly

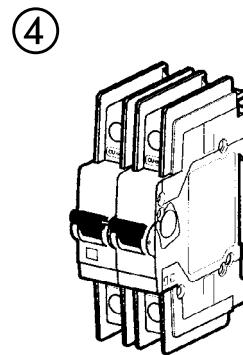
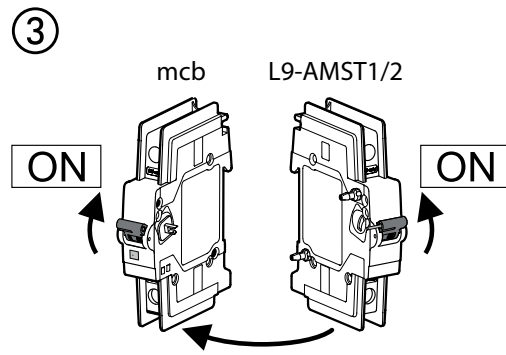
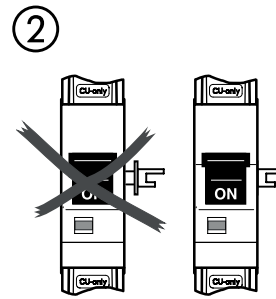
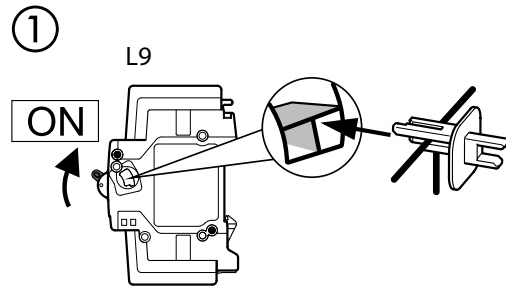



Sprecher + Schuh US Division Headquarters
15910 International Plaza Drive
Houston, TX 77032

Customer Service: (877) 721-5913
Fax: (800) 739-7370

Sprecher + Schuh Canadian Deivision
10 Spy Court
Markham, ON L3R 5H6

Customer Service: (905) 475-6543
Fax: (905) 475-0027

www.sprecherschuh.com

L8 Supplemental Protectors L9 Miniature Circuit Breakers Series B

Cross Reference

CROSS-L8L9-B-114 02/2014

Sprecher + Schuh has provided reliable control and protection solutions for its customers since 1903.

Today, Sprecher + Schuh offers a wide range of low-voltage industrial control products, including contactors, a variety of relays, starters, push buttons, switches, terminals and controllers, to name a few. All of our products are crafted with precision and tested rigorously for performance — far exceeding industry standards. Moving forward, we continue along the path of constantly seeking innovative ways to provide solutions for our customers. It is by this philosophy that Sprecher + Schuh has come to be the industrial control manufacturer of choice for many customers around the globe seeking quality, reliability, and a name they can trust.